

Base Map Features

- Federal Highway
- State Highway
- County Highway
- Town Road
- Recreation Trail
- Railroad
- County Boundary
- City/Village Boundary
- Township Boundary
- Public Land
- Surface Water

Zoning Map
Town of Riverview
Oconto County, Wisconsin

Zoning Districts

- Mobile Home Park
- Residential Multiple Family
- Residential Single Family
- Agricultural
- Forest
- Rural Residential
- Community Service
- General Commercial
- Industrial
- Large Scale Agricultural
- Light Industrial
- Neighborhood Commercial
- Park and Recreation
- Restricted Commercial

Zoning Overlay Districts

- Adult Entertainment Overlay
- Airport Height Limitation
- Conservancy
- Quarrying

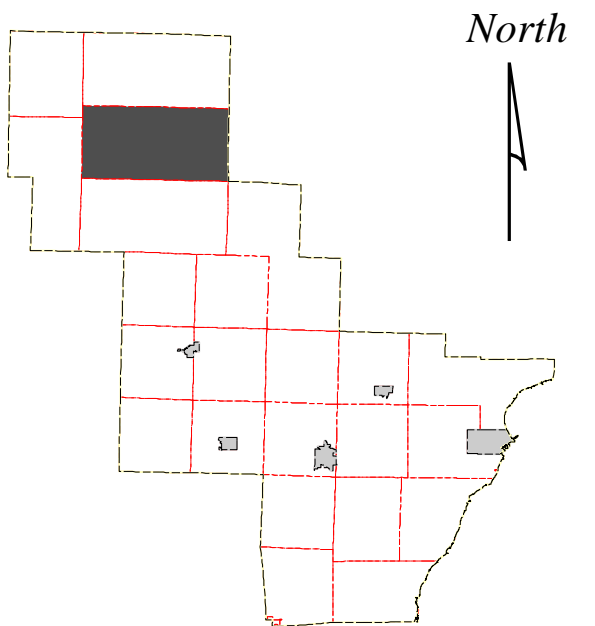

This map is neither a legally recorded map nor a survey and is not intended to be used as such. This map contains a compilation of records, information, and data to be used for reference purposes only. Oconto County is not responsible for any inaccuracies herein contained. Please contact the Oconto County Planning & Zoning Office at 920.834.6827 with any questions.

Source: Oconto County Planning, January 2022
0 0.25 0.5 1 Miles

